



FMTKB Series

In-Line Paddle Wheel Flow Meter

- ✓ Quick Installation
- ✓ Industry's Highest Accuracy: $\pm 0.5\%$
- ✓ LED Flow Indicator

- ✓ Low Pressure Drop
- ✓ NEMA 4X | IP 66 Protection
- ✓ True 1" Union Design



Engineered for accuracy, ruggedness and longevity

The FMTKB Series digital in-line flow meters are easy to install with exceptional long-life performance. They are highly repeatable, extremely rugged sensors that offer outstanding value and require no scheduled maintenance.

The FMTKB Series has a process-ready output signal with a wide dynamic flow range of 0.3 to 33 ft/s | 0.1 to 10 m/s.

FMTKB Series flow meters are designed to be used with the PF, SF, & EF series drum pumps. Offered in 3/4" - 1" hose barb connection sizes, along with material options of unfilled Polypropylene or PVDF, which makes this meter highly adaptable and chemically resistant to many corrosive liquid process applications. Unfilled Polypropylene models are suitable for Sodium Hypochlorite (Bleach).

The FMTKB Series flow meter bodies are true-union designed and come with a bright LCD Display that rotates 360°.

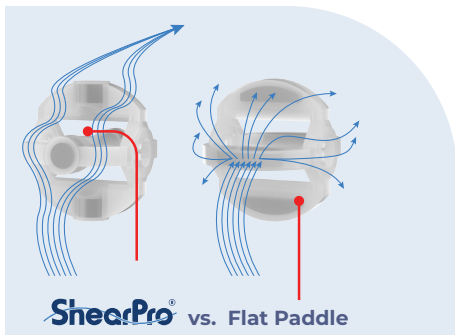

New ShearPro® Design

- ✓ Contoured Flow Profile
- ✓ Reduced Turbulence = Increased Longevity
- ✓ 78% Less Drag than Old Flat Paddle Design*

*Ref: NASA "Shape Effects on Drag"

ETFE Paddle Wheel

- ✓ Superior Chemical And Wear Resistance vs PVDF

Zirconium Ceramic Rotor | Bushings

- ✓ Up to 15x the Wear Resistance vs. Regular Ceramic
- ✓ Integral Rotor Bushings Reduce Wear and Fatigue Stress

ShearPro® Through-Pin Design

- ✓ Eliminates Finger Spread
- ✓ No Lost Paddles
- ✓ Increased Temp. Rating
- ✓ 360° Housing Protects Rotor

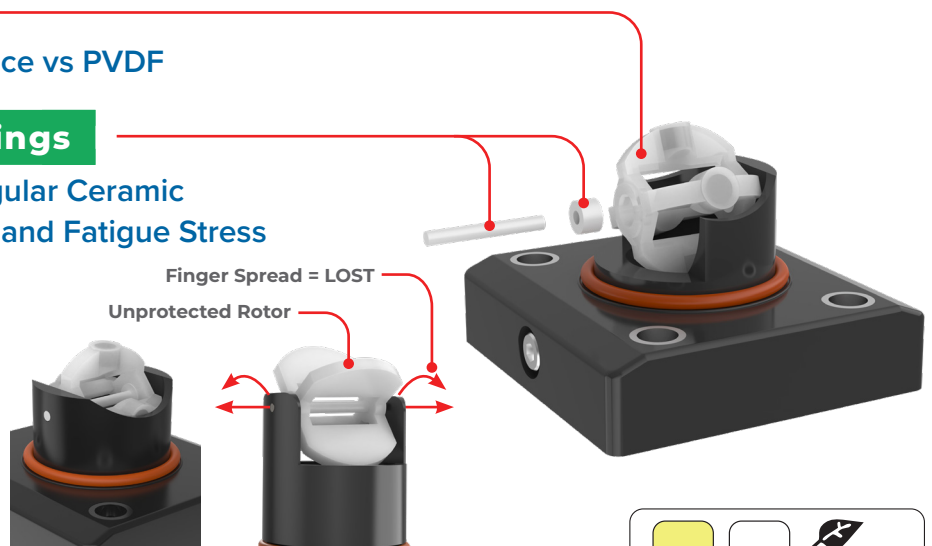

ShearPro® vs. Competitor 'A'



FMTKB Series

In-Line Paddle Wheel Flow Meter

Specifications

General						
Operating Range	0.3 to 33 ft/s		0.1 to 10 m/s			
Connection Range	3/4 to 1"		DN20 to DN25			
Linearity & Repeatability	±0.5% of F.S @ 25°C 77°F					
Wetted Materials						
Sensor Body	Unfilled Polypropylene (Pigmented) PVDF (Natural)					
O-Rings	FKM					
Rotor Pin & Bushings Paddle	Zirconium Ceramic (ZrO2) ETFE					
Electrical						
Battery	3 VDC					
Max. Temperature/Pressure Rating - Standard and Integral Sensor						
Polypropylene (PP)	180 psi @ 68°F 40 psi @ 190°F		12.5 bar @ 20°C 2.7 bar @ 88°C			
PVDF	200 psi @ 68°F 40 psi @ 240°F		14 bar @ 20°C 2.7 bar @ 115°C			
Operating Temperature						
Polypropylene (PP)	-4°F to 190°F		-20°C to 88°C			
PVDF	-40°F to 240°F		-40°C to 115°C			
Outputs						
FMTKB Series	Flow Frequency Pulse - Total					
Standards and Approvals						
CE FCC RoHS Compliant						
Pump Model	PF Series		SF Series		EF Series	
Material	Polypropylene	PVDF	Polypropylene	PVDF	Polypropylene	PVDF
Flow Meter Part Number	211013	211013-1	211013-2	211013-3	211013-4	211013-5

Temperature | Pressure Graphs

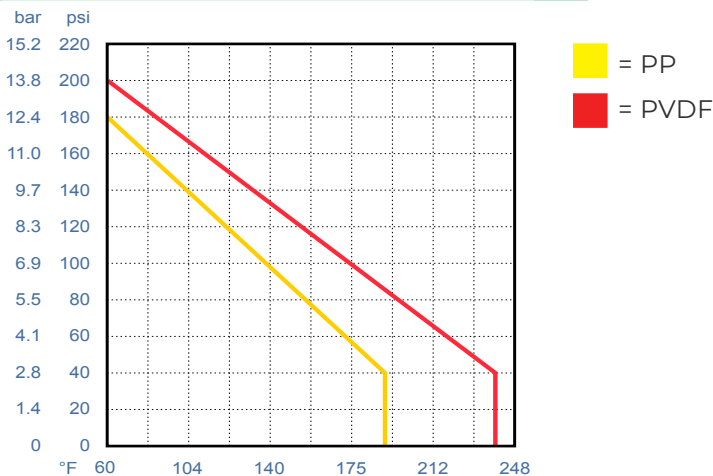

Dispensing Accessories

Squeeze Lever Nozzle



- PP
- PVDF
- Aluminum
- Stainless Steel

Discharge Hose



- Fiber Reinforced PVC
- EPDM
- UHMW Polyethylene

See Drum Pump Accessories flyer for additional information